

The logo consists of a dark red rounded square containing the text 'M2M' in a large, bold, white sans-serif font, with the word 'SERVICES' in a smaller, white sans-serif font directly below it. The background of the slide features a series of thin, light brown curved lines that sweep from the top left towards the center.

M₂M
SERVICES

M2M Services

M2M Smartphone Application Overview

v.2.0

First steps with the RControl app and login instructions

Depending on your phone you can get the application from Apple App Store, Android PlayStore and Windows Store.

Once you download and install the app, use the credentials from the quick install manual to log in your account.

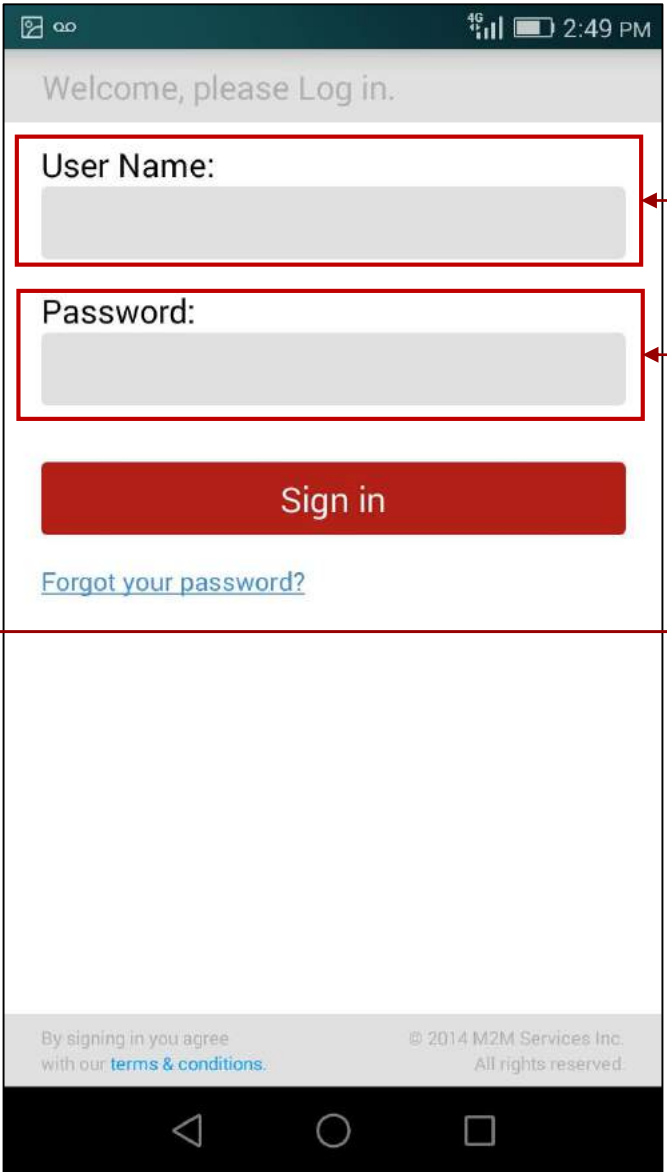

Upon initial log-in you will be prompted to enter a password reset e-mail. We strongly recommend that you do that from the very beginning. If you choose to postpone – select "Ask me later"

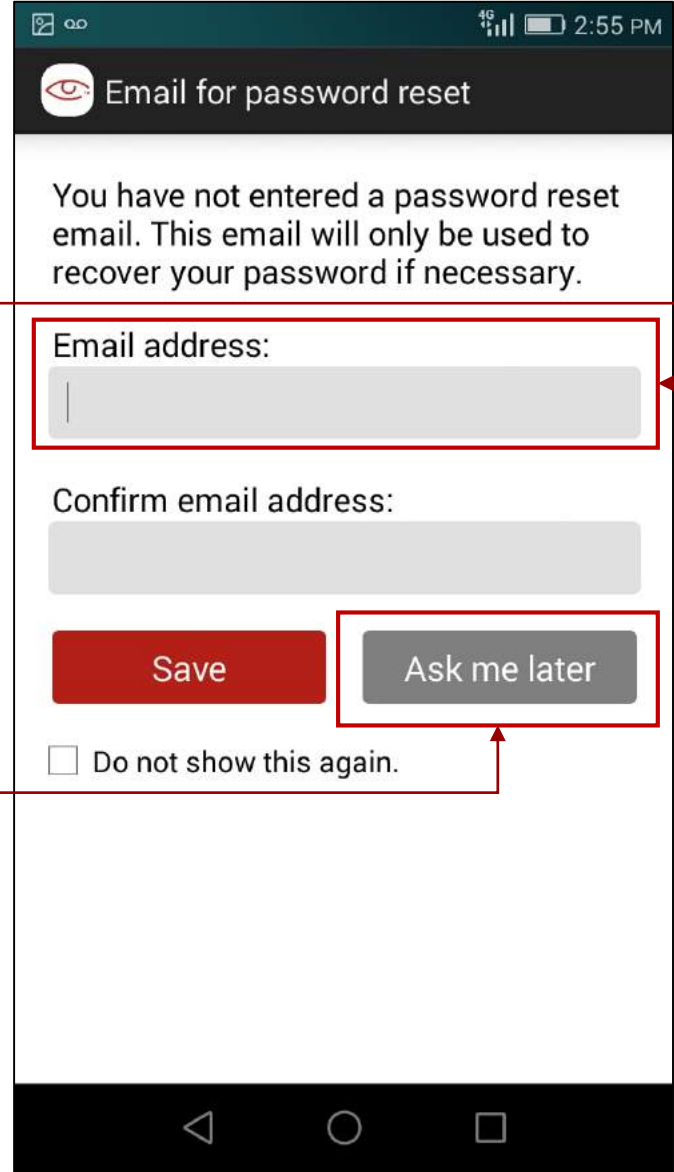

First look

Upon first start, the only active functionality will be the events log.

To access the main menu click here.

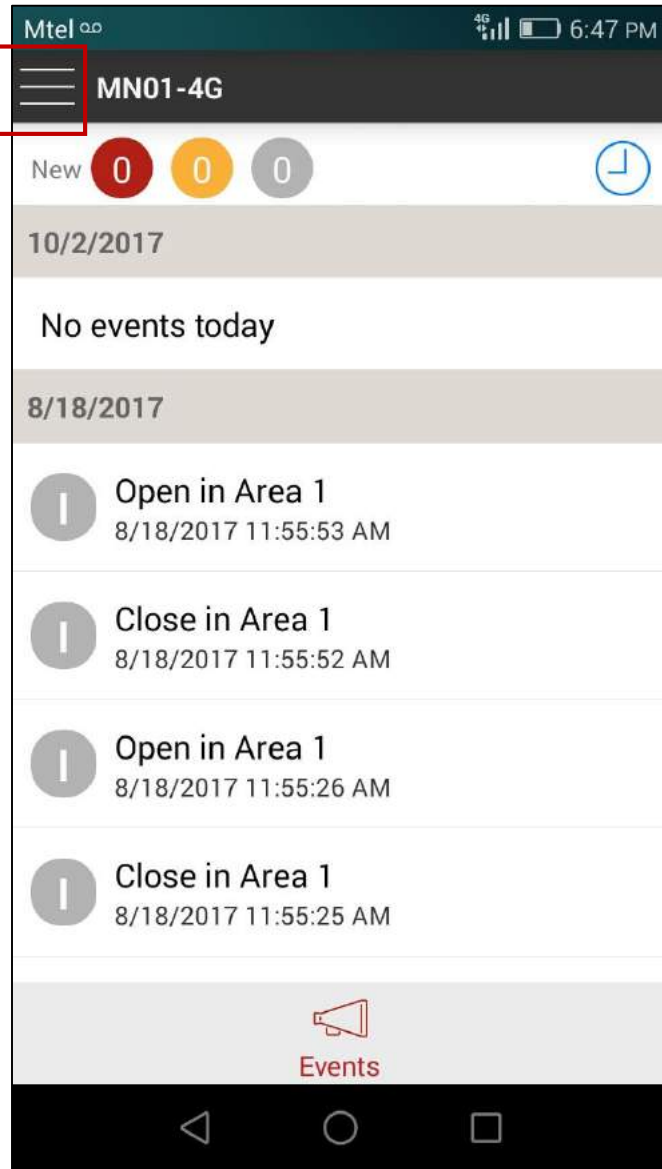

Go to settings to configure the App

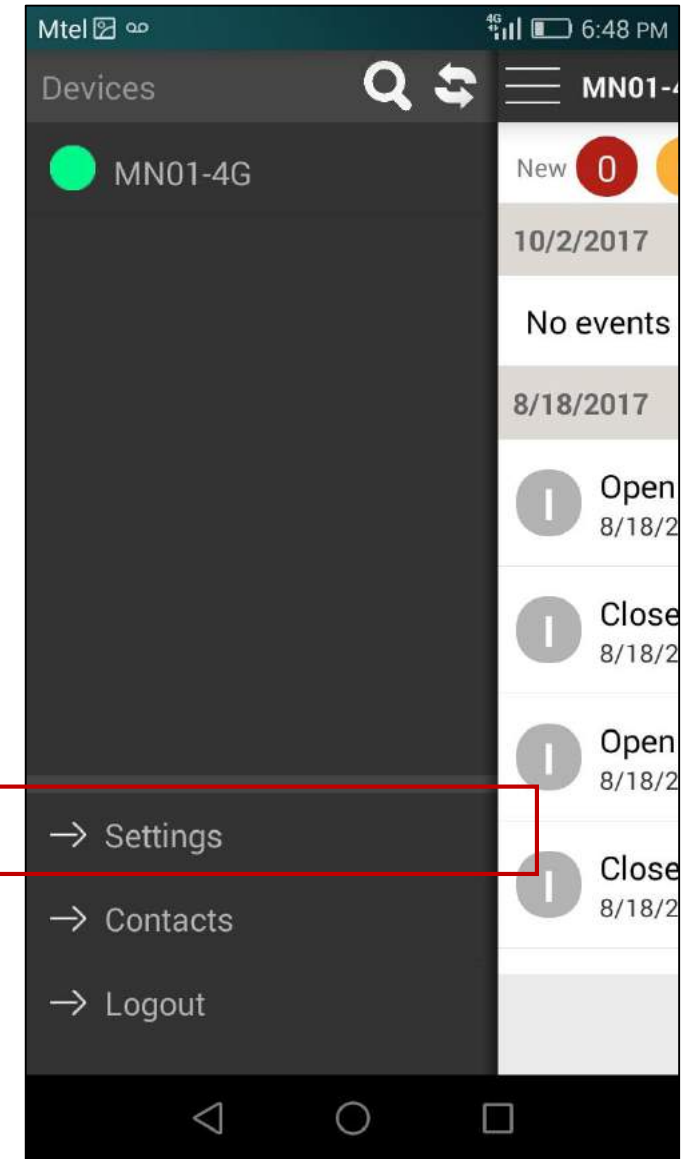

Changing your username and password

Go to “My Account” if you want to change your login credentials, account name and e-mail

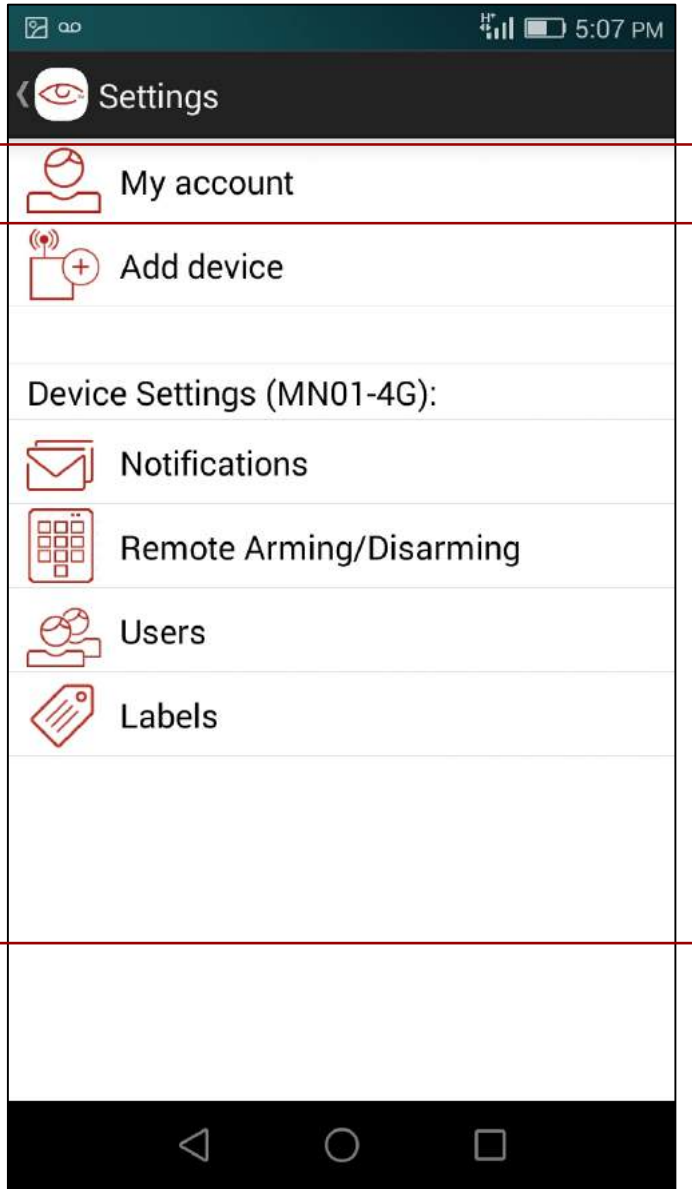

For additional security you will be prompted to enter your login password again

Fill in the desired fields and press “Save profile” when done.

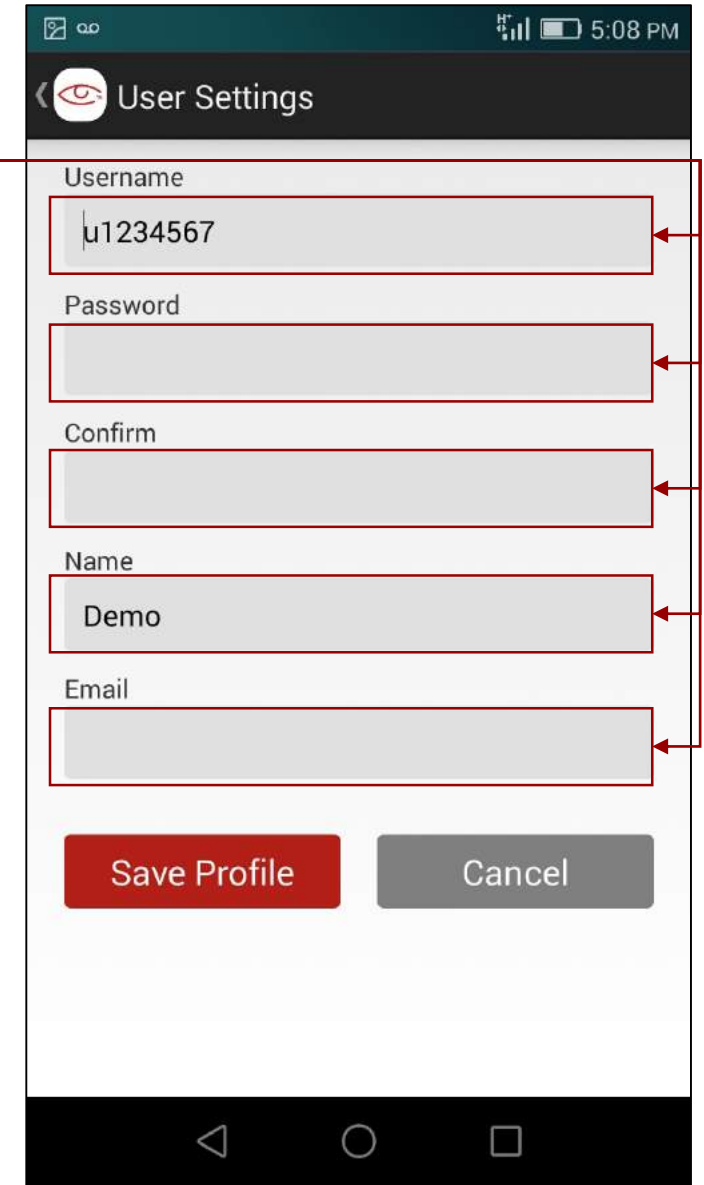
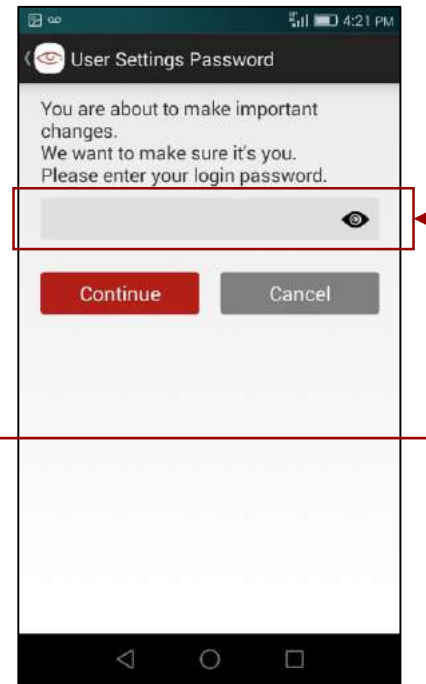

Notifications

Go to “Notifications” to choose how you would like to receive the different events on your smartphone.

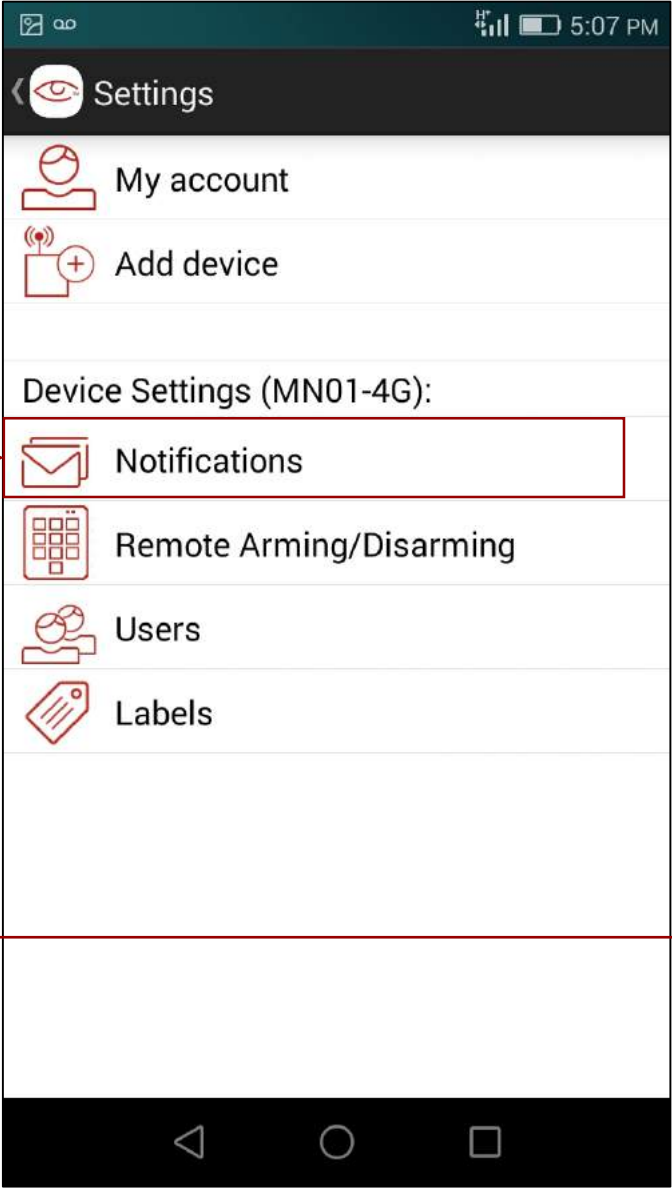

Click on “add” (the +) in the top right corner to go to the available options

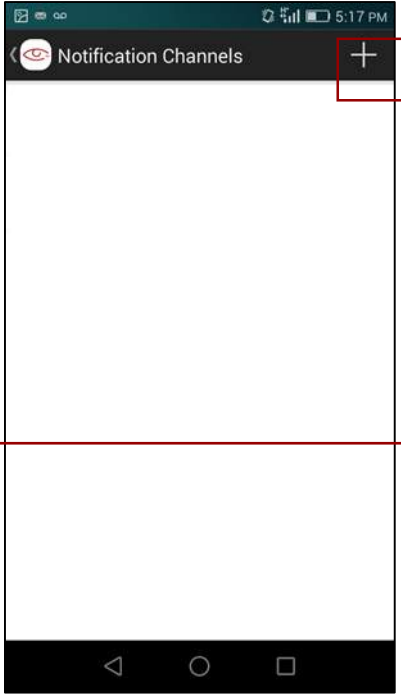

Choose your preferred way/s of notification. You can also select both.

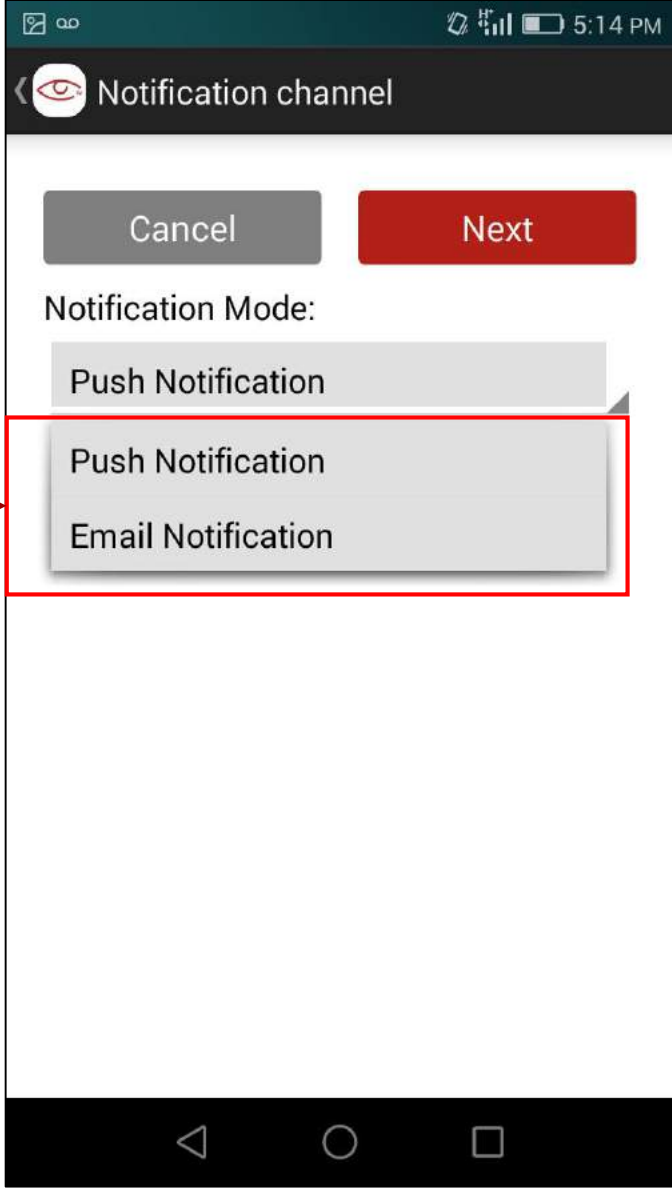

Notifications - continued

Select type of events to be reported for each notification channel.

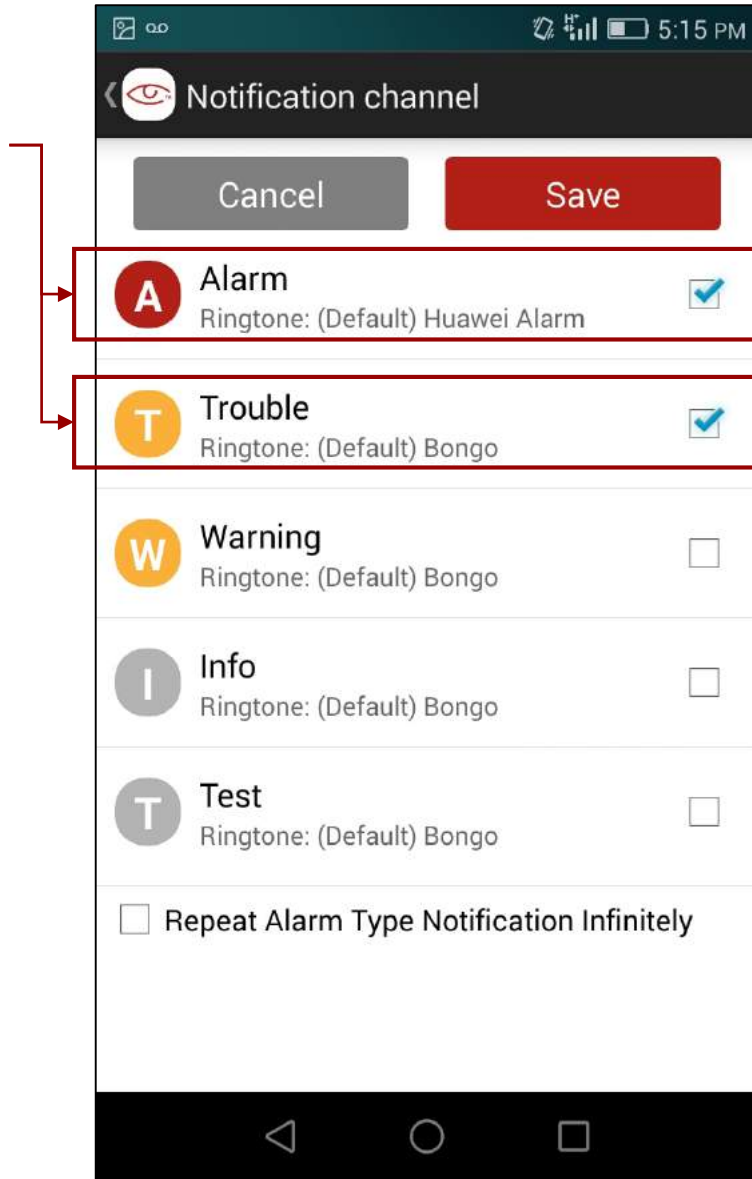

Once selected, the active notification channels will be displayed, with the ability to edit, add new or remove.

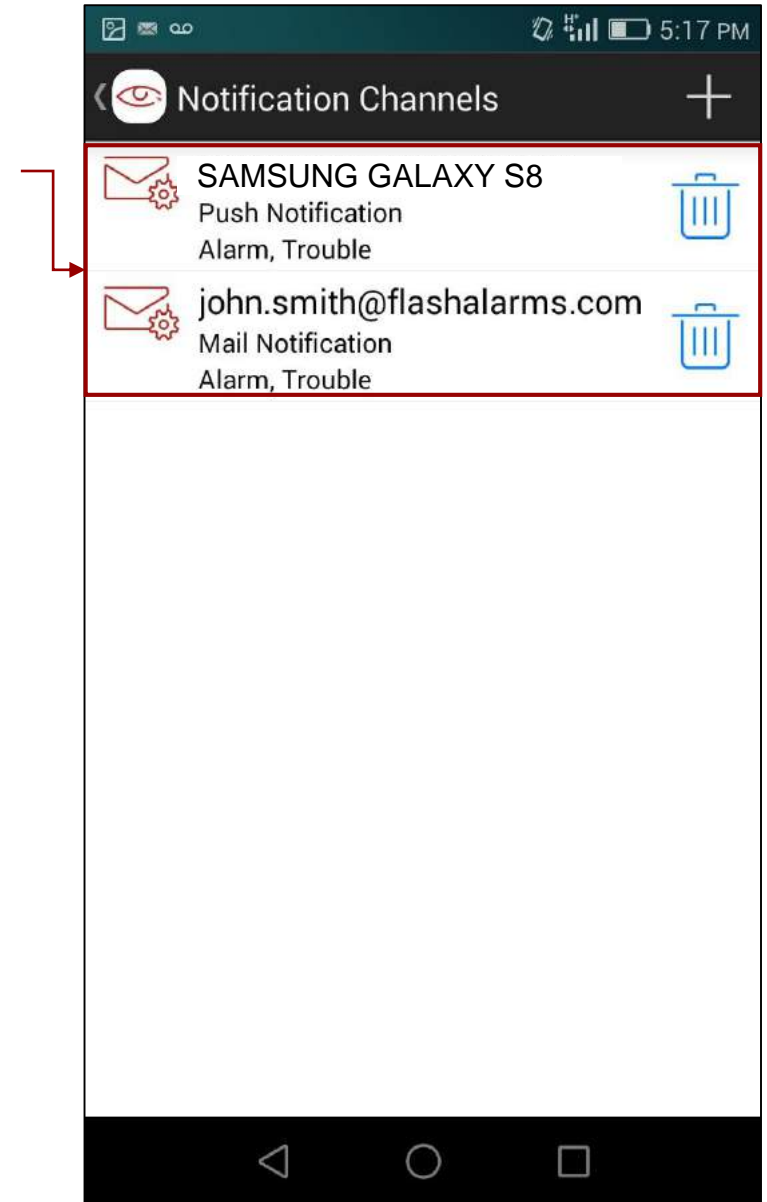

Remote Arming/Disarming

To enable this functionality, additional wiring and configuration of the alarm panel must be completed by the installer.

Go to "Remote Arming/Disarming" to setup this functionality

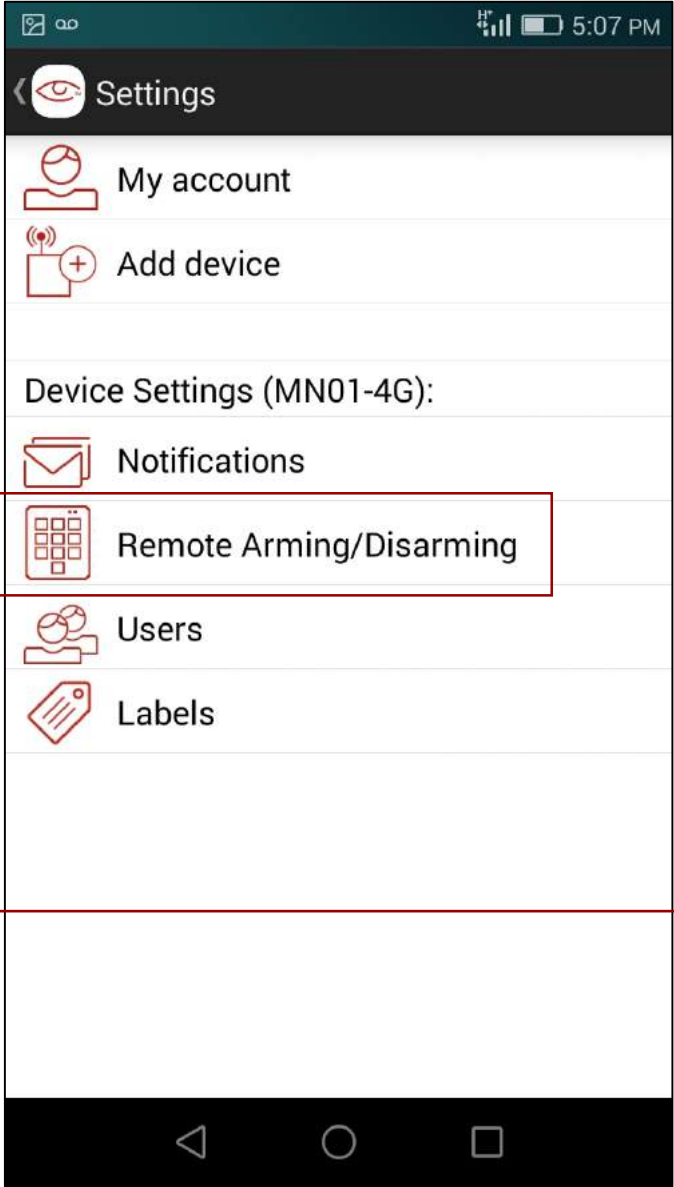

For additional security you will be prompted to enter your login password again

Slide to enable the Remote arming/disarming

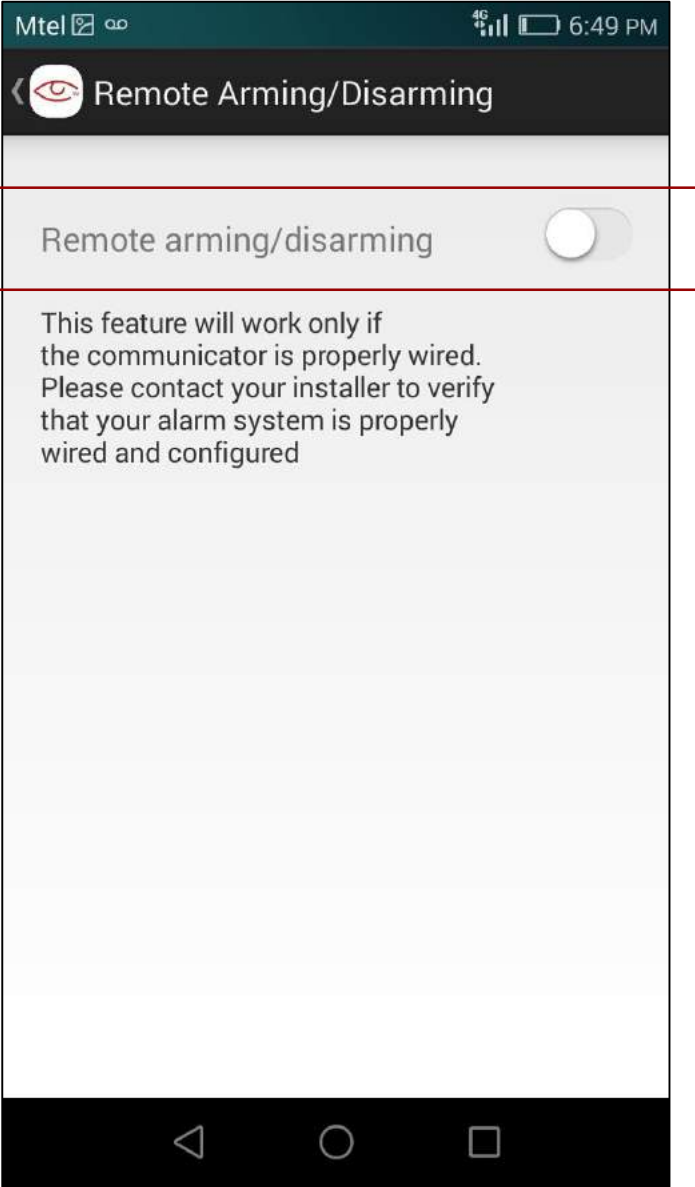
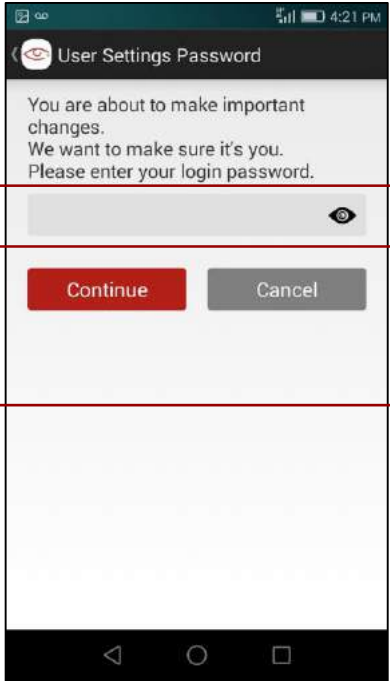

Remote Arming/Disarming - continued

To enable this functionality, additional wiring and configuration of the alarm panel must be completed by the installer.

Upon first activation, you will be asked to set the PIN for the remote ARM/DISARM.

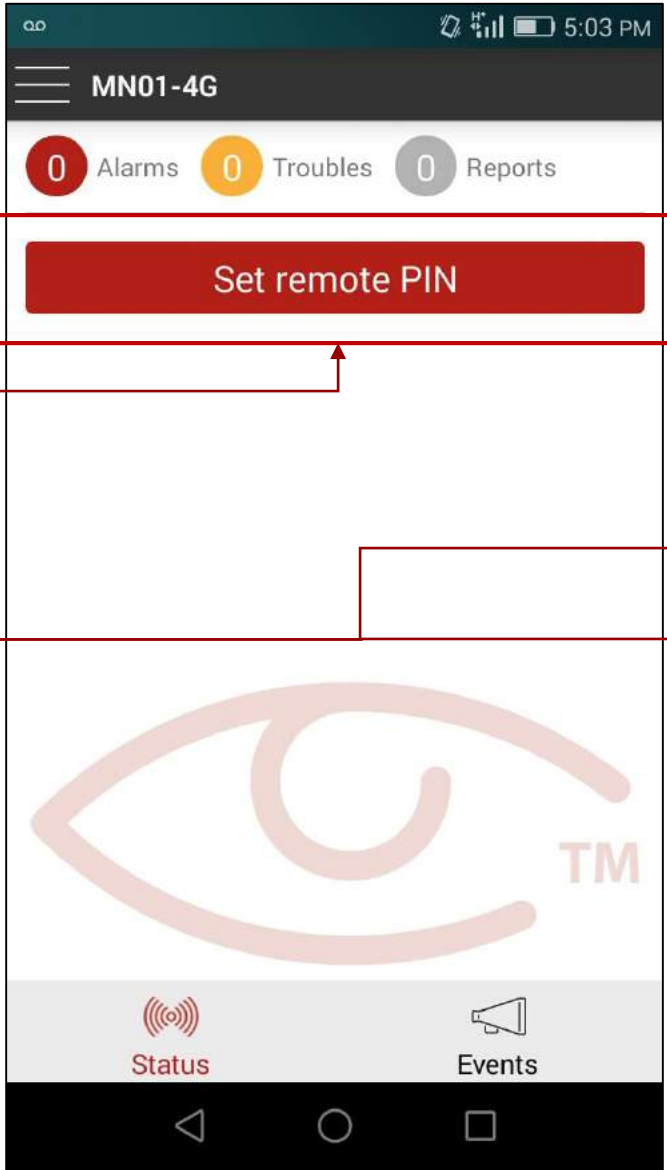

Enter and confirm your 4-digit PIN then press "Continue"

To complete the initial pairing procedure you must arm and disarm the alarm panel locally (from the keypad) within 2 minutes.

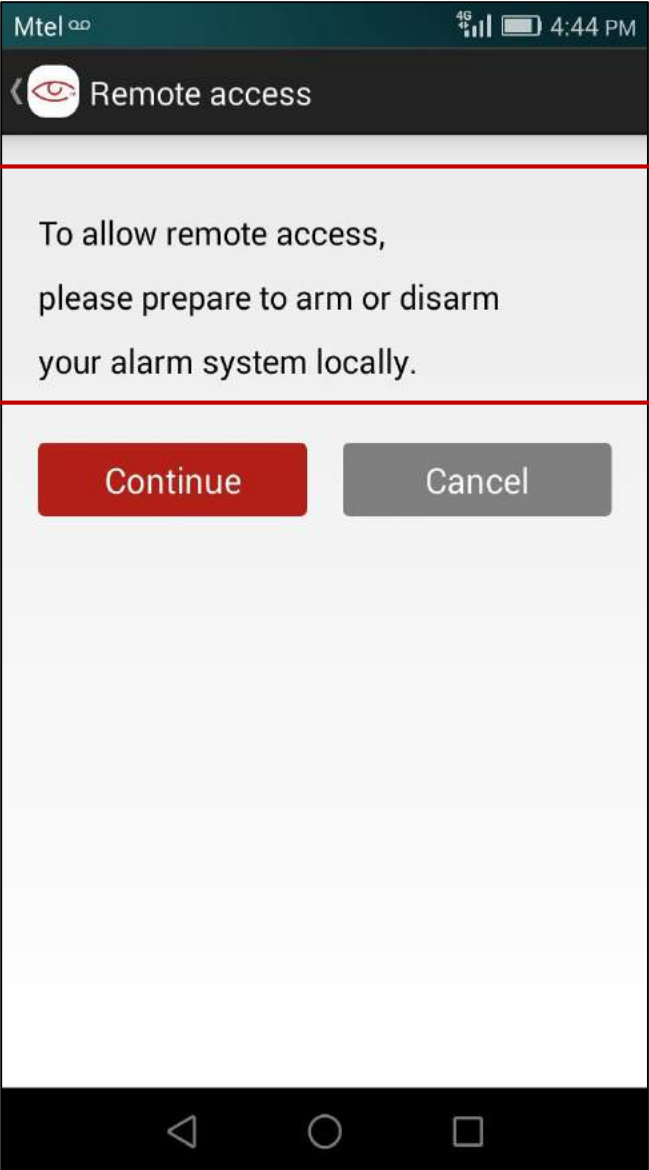
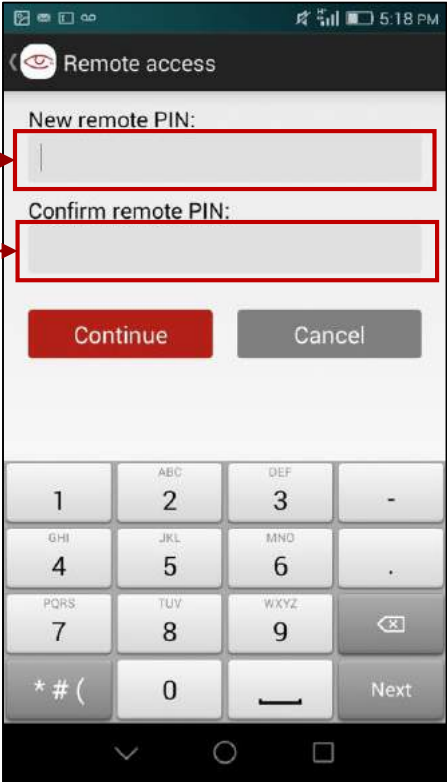

Remote Arming/Disarming - continued

To enable this functionality, additional wiring and configuration of the alarm panel must be completed by the installer.

In case you forgot your PIN you need to deactivate and then activate again the Remote arming/disarming function and you will be prompted to choose a PIN and then confirm it.

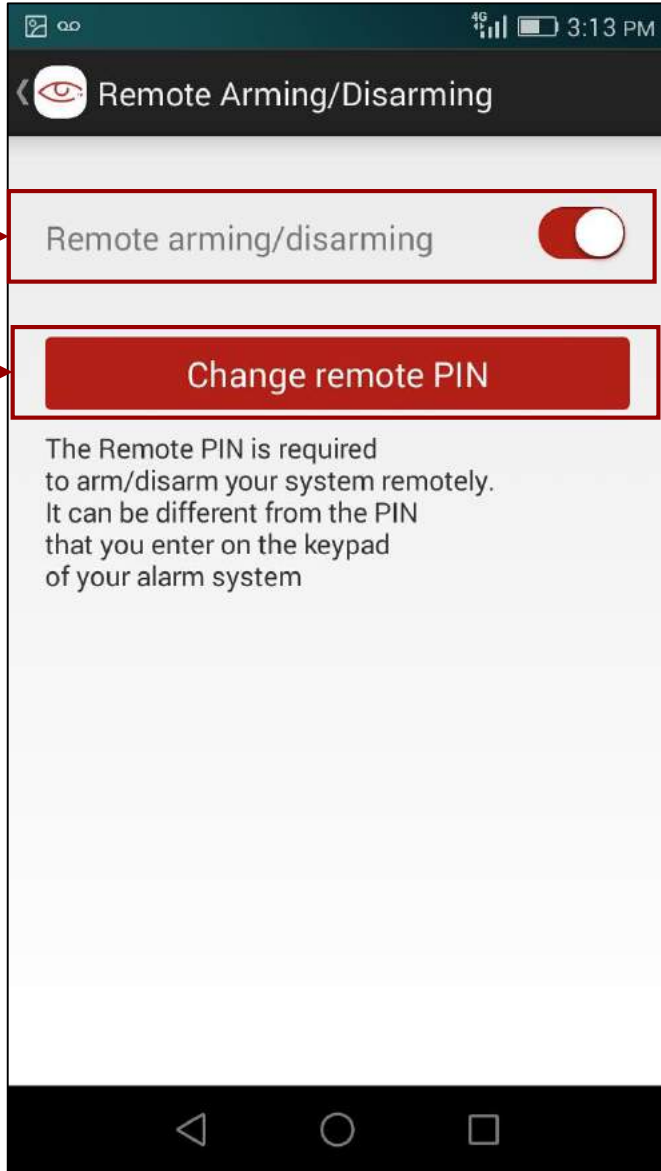

To simply change your existing PIN – press the red button

Once you select the Change remote PIN – you have to input the old one, followed by the new one twice and press Continue to confirm.

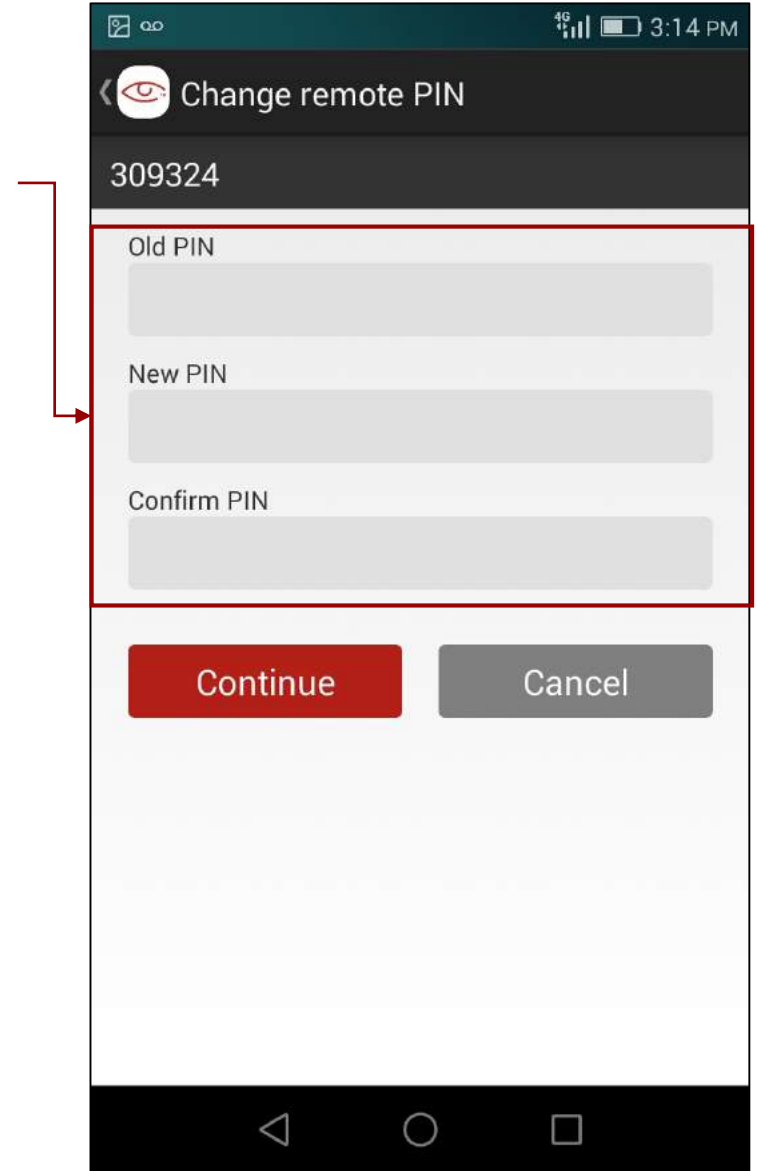

Users

Go to “Users”
menu if you
want to add,
remove, or edit
the users

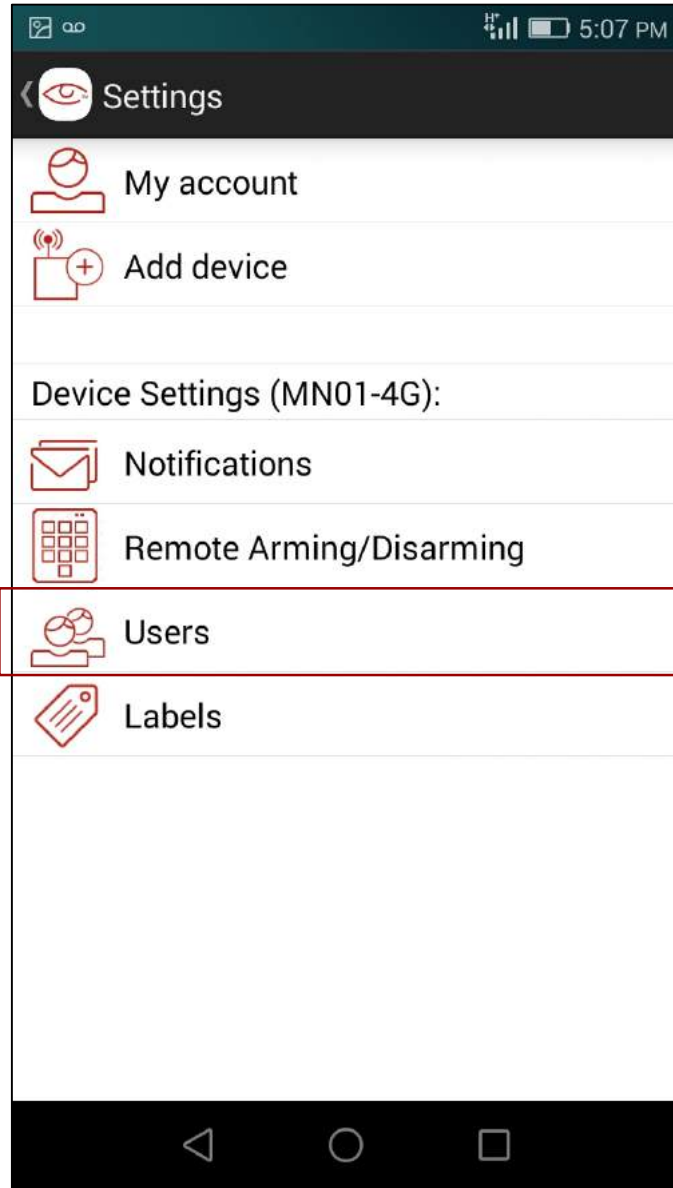

Users - continued

Select "Create new user" if you want to add more users who can manage this device (e.g. spouse, kids, relatives)

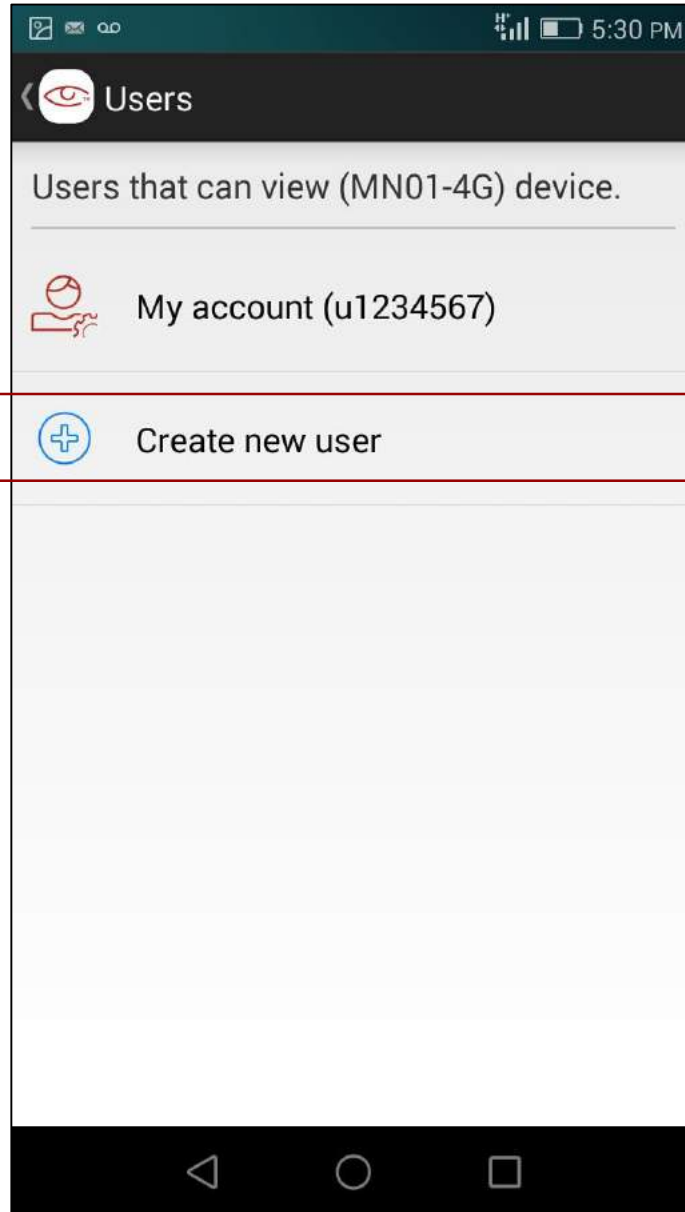

Populate the necessary data in the following screen

If you want them to have the option for remote ARM/ DISARM, here you have to give them the permission for that.

Only master users have the ability to add new users and new devices. For safety reasons, we recommend that you have only one master user.

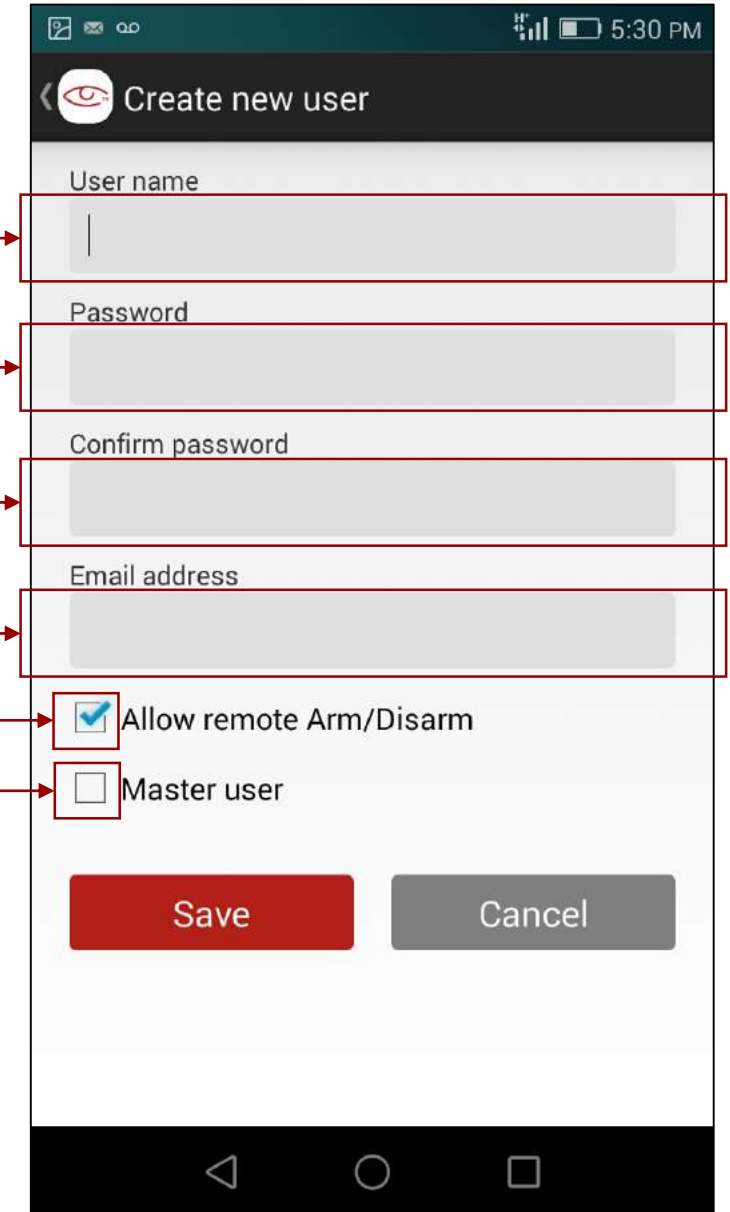

Labels

Go to “Labels” menu if you want to name your partitions, zones and users.

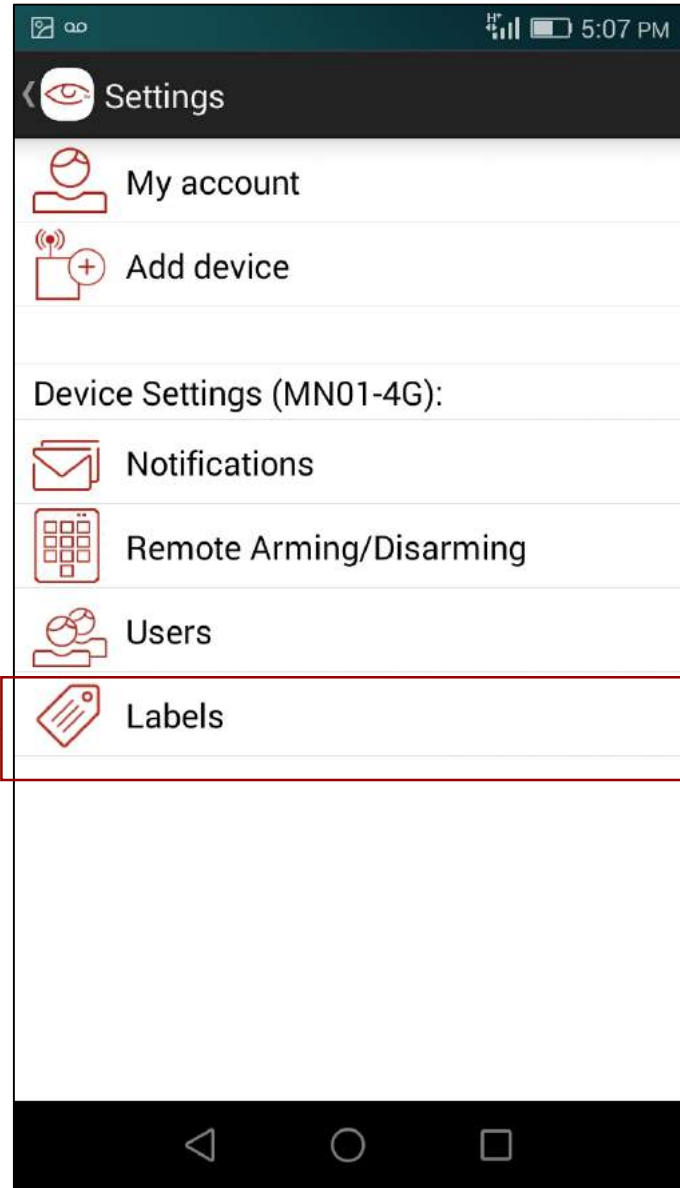

To add new partition select “Add new partition”.

To add Zones and Users use the respective tabs.

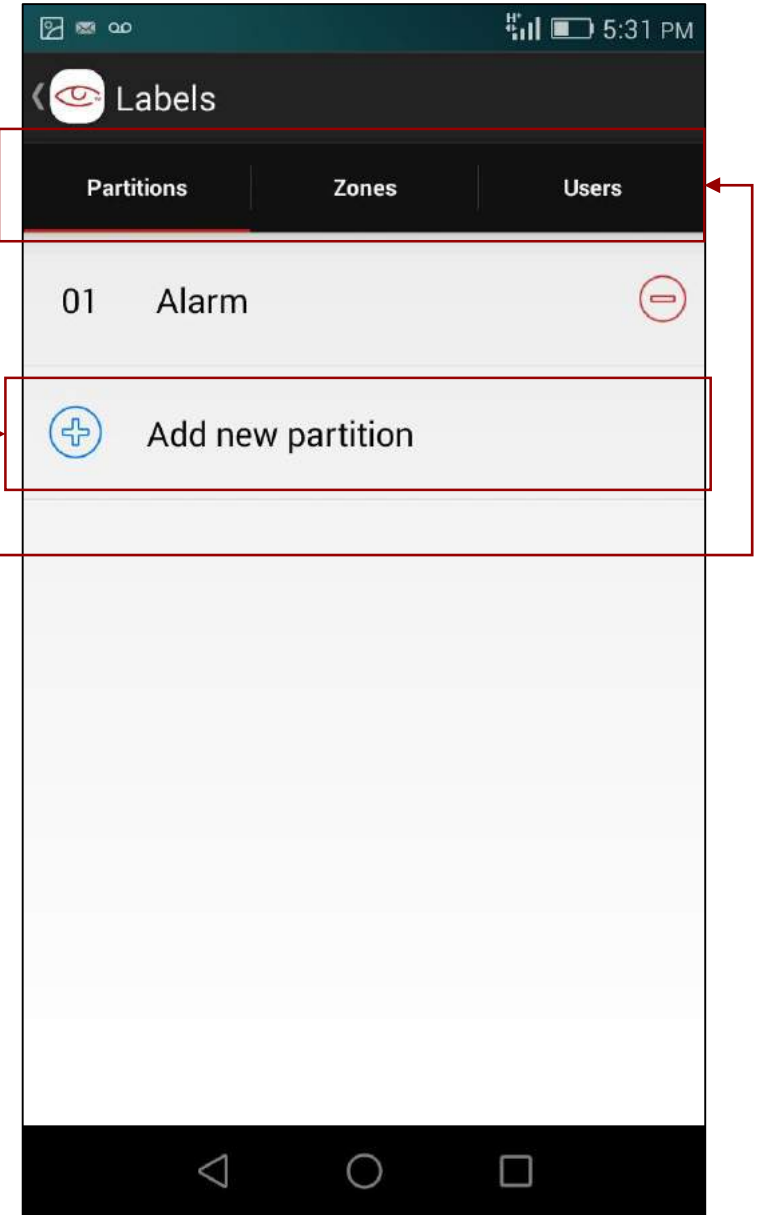

Labels - continued

You can add and/or rename all partitions, zones, and Users from the Labels submenu

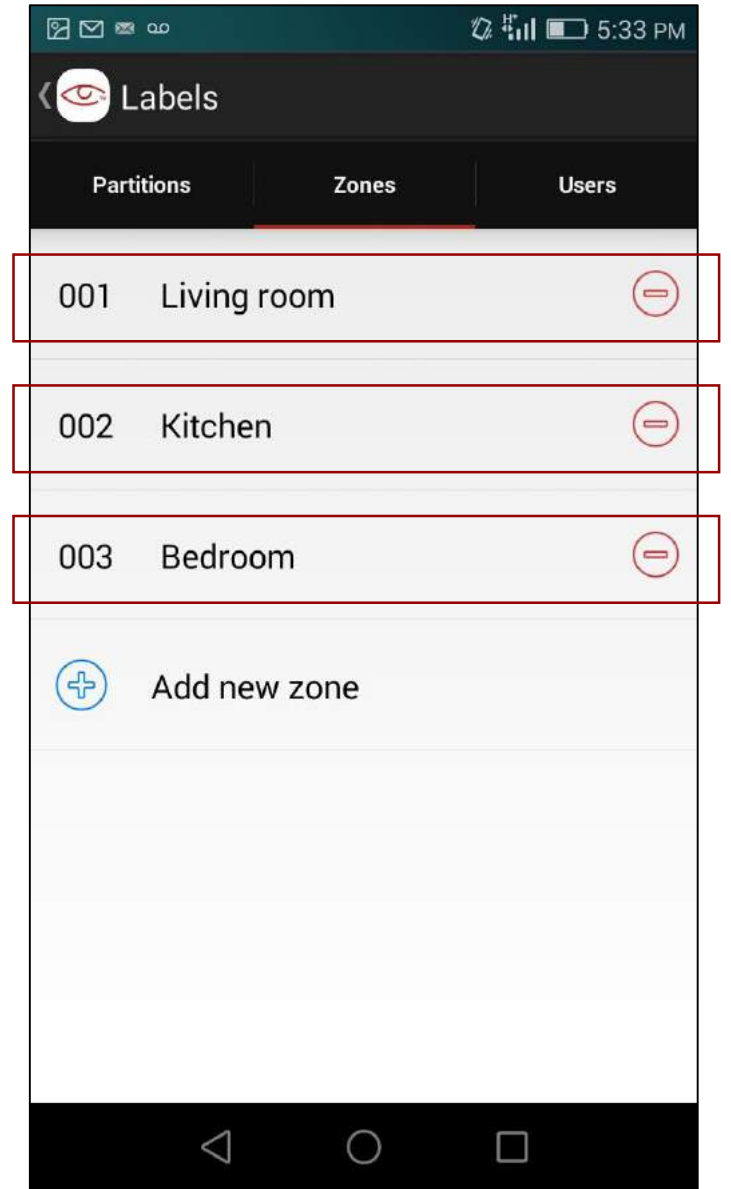
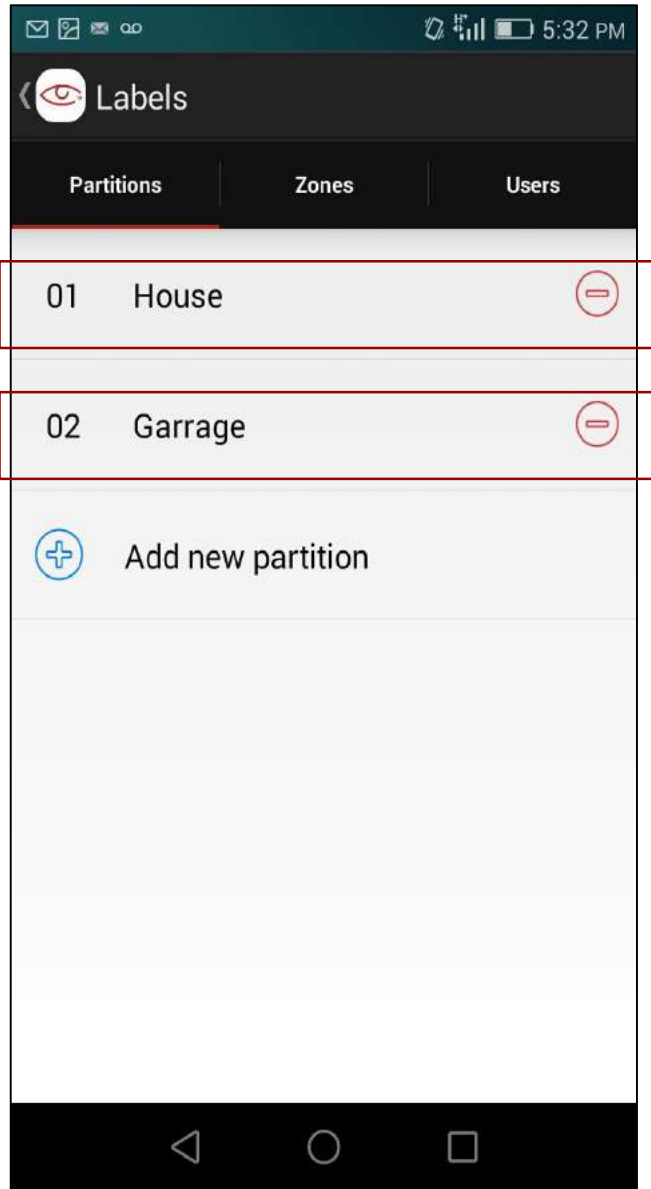

History of events

Select "Events from the main screen to see a list of the events back in time (history of events is kept for 12 months)

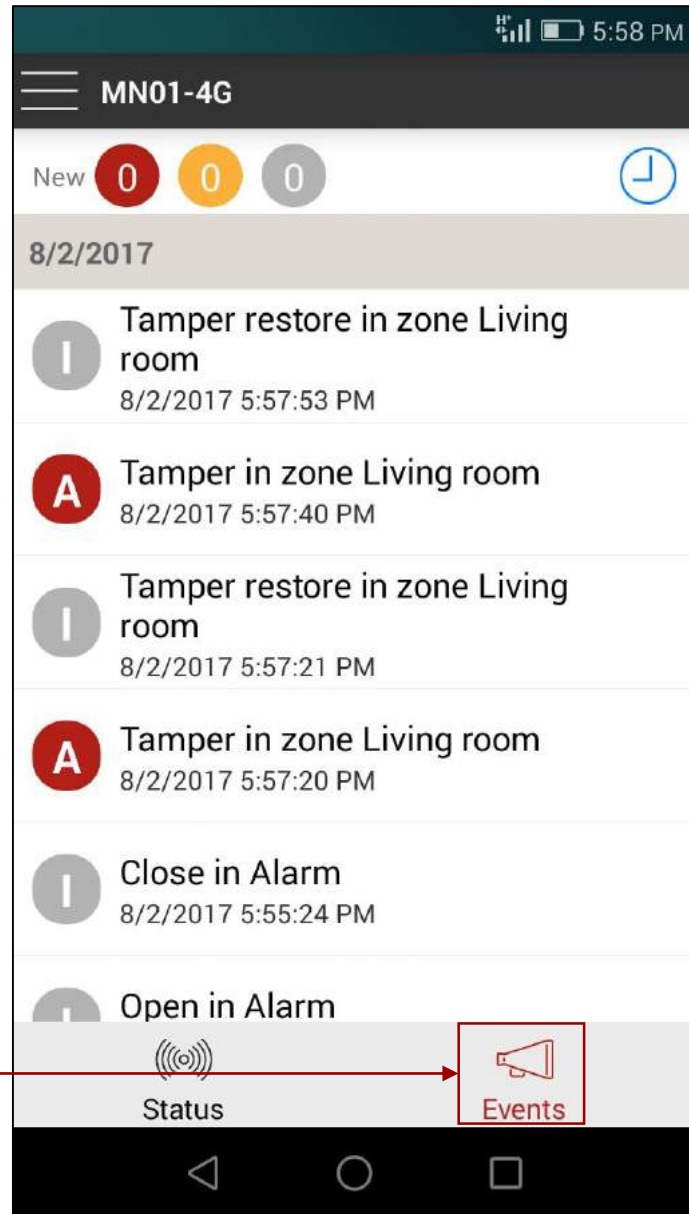

Adding more devices to your account

Go to “Add Device” if you want to manage additional devices from the same account

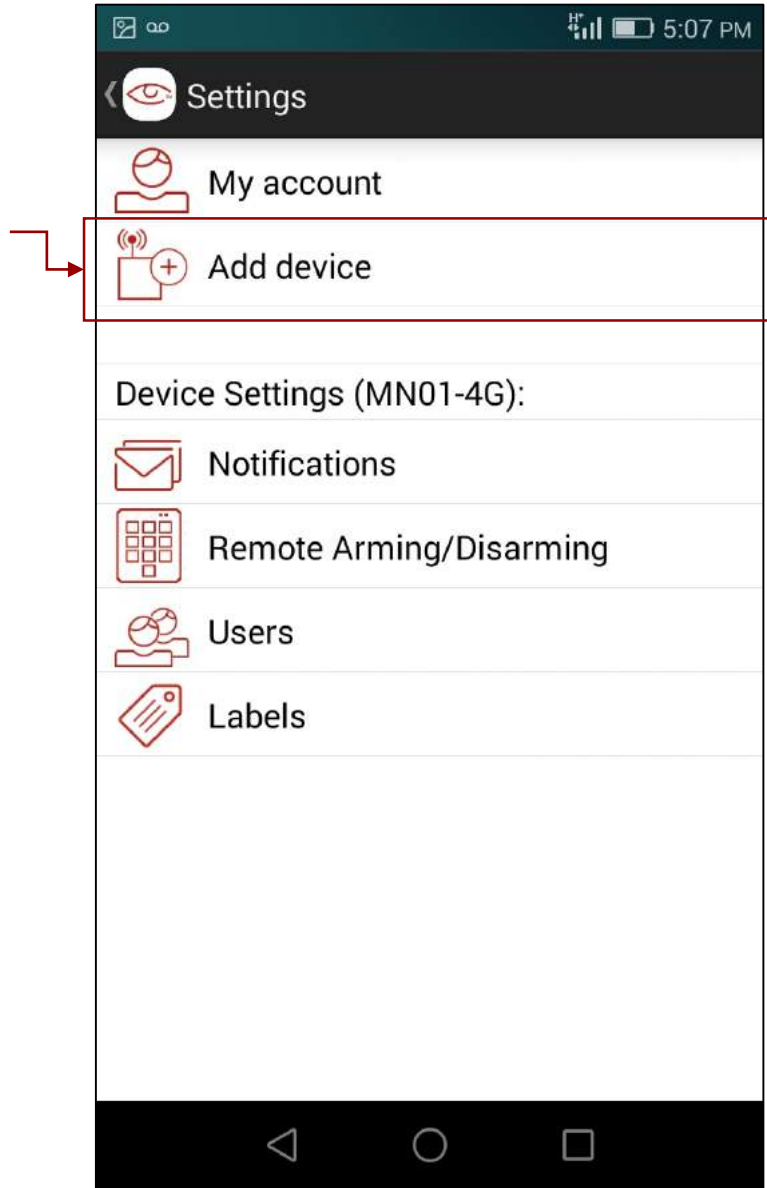

Enter the serial number of the MiNi01-4G device that you want to add to this account and the login credentials that come with it's manual (for new devices).

For devices that have already been in use – you will have to provide the current username and password.

You can manage up to 100 devices from a single account.

